

LOG MOULDER PROFILES

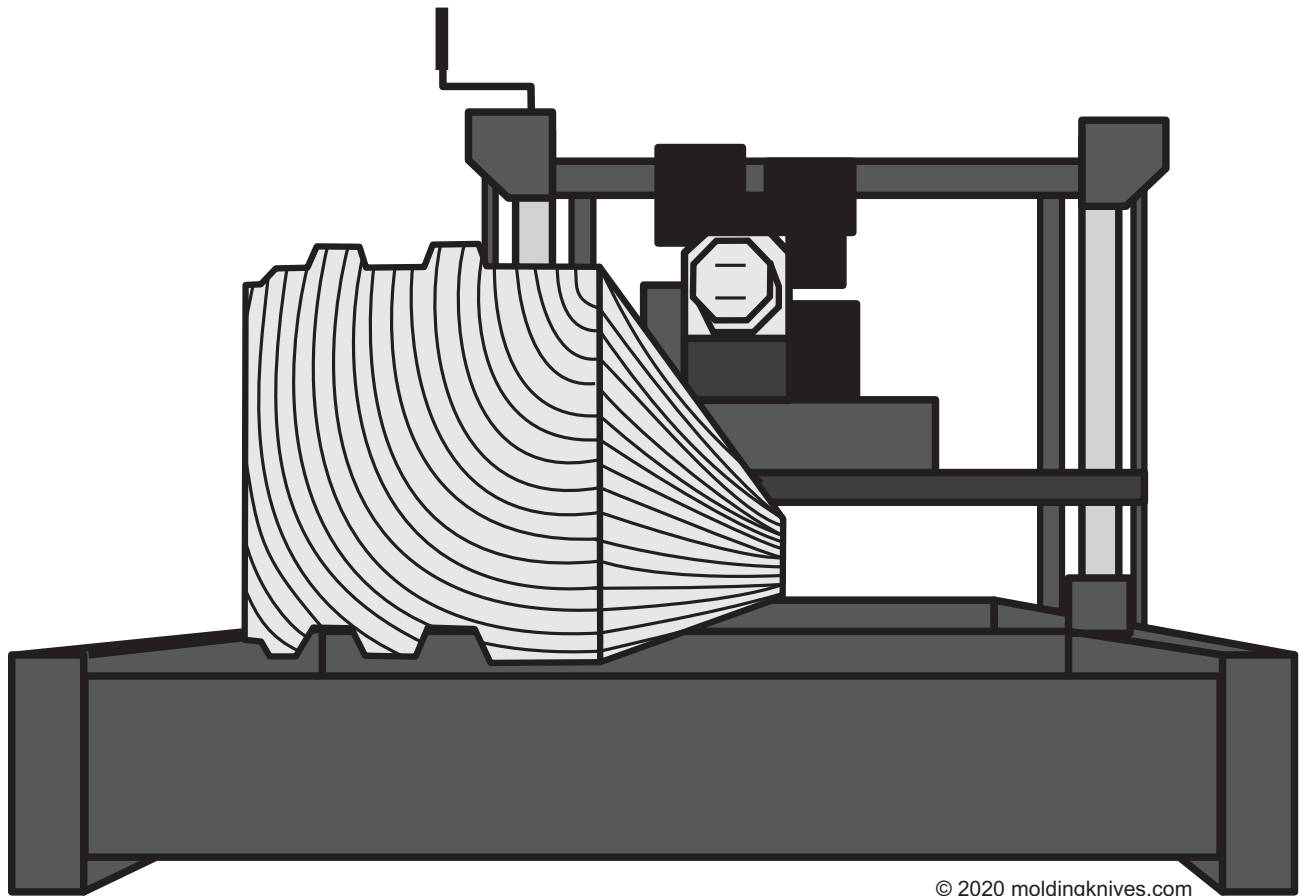

© 2020 moldingknives.com



moldingknives.com

Drawings are NOT actual size.

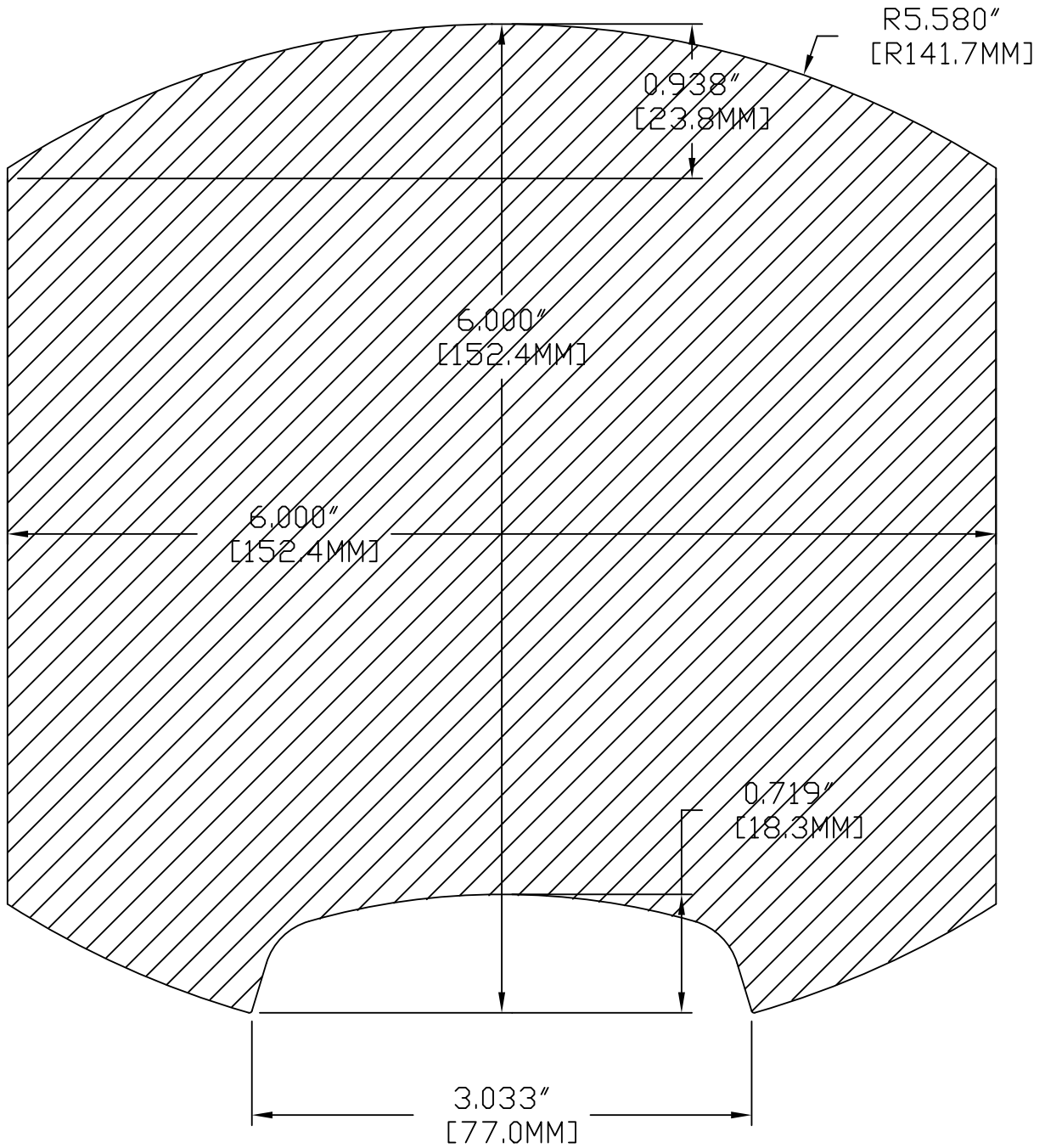

Log Moulder Profile #LM01

Drawings are NOT actual size.

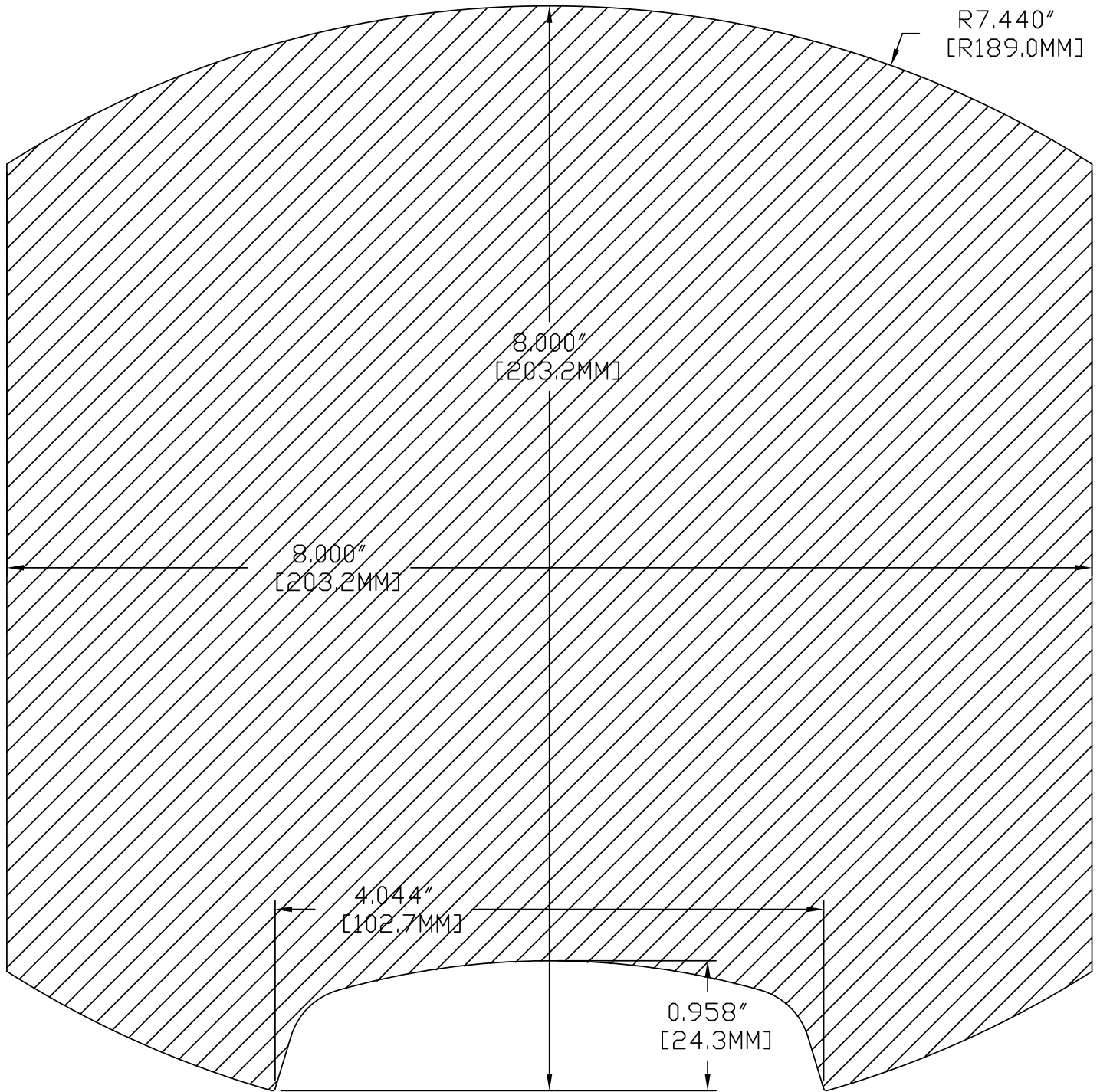

Log Moulder Profile #LM02

Drawings are NOT actual size.

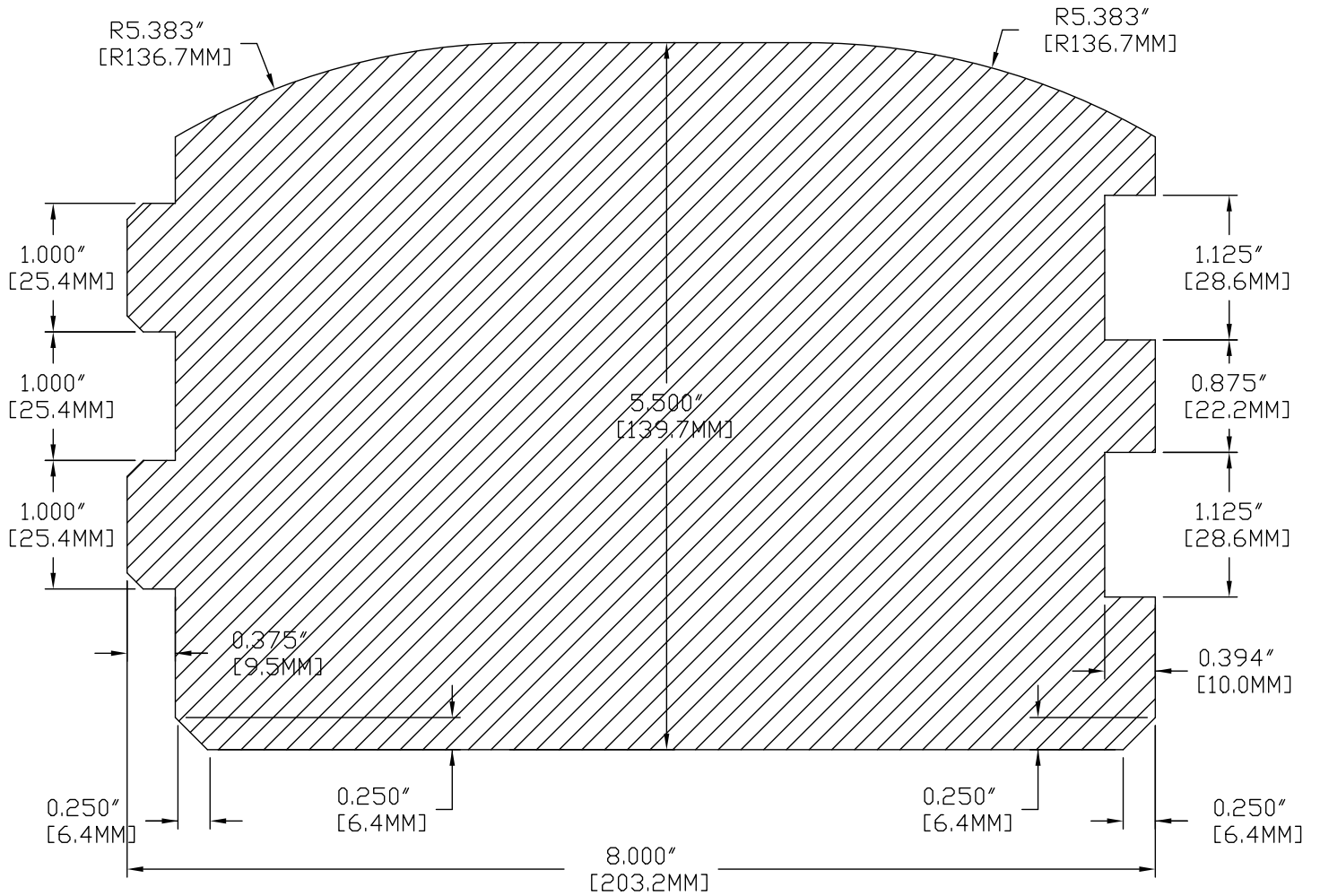

Log Moulder Profile #LM03

Drawings are NOT actual size.

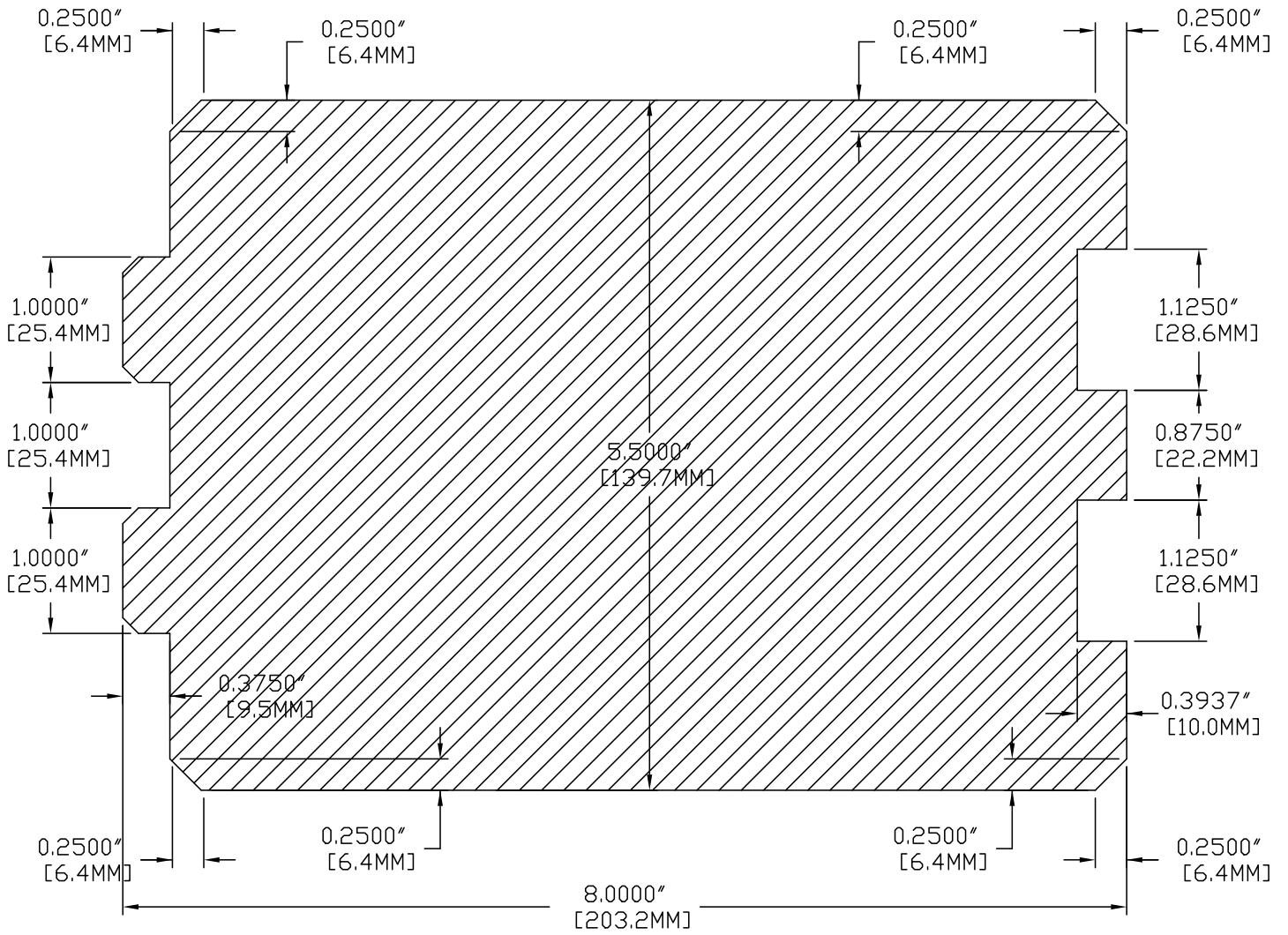

Log Moulder Profile #LM04

Drawings are NOT actual size.

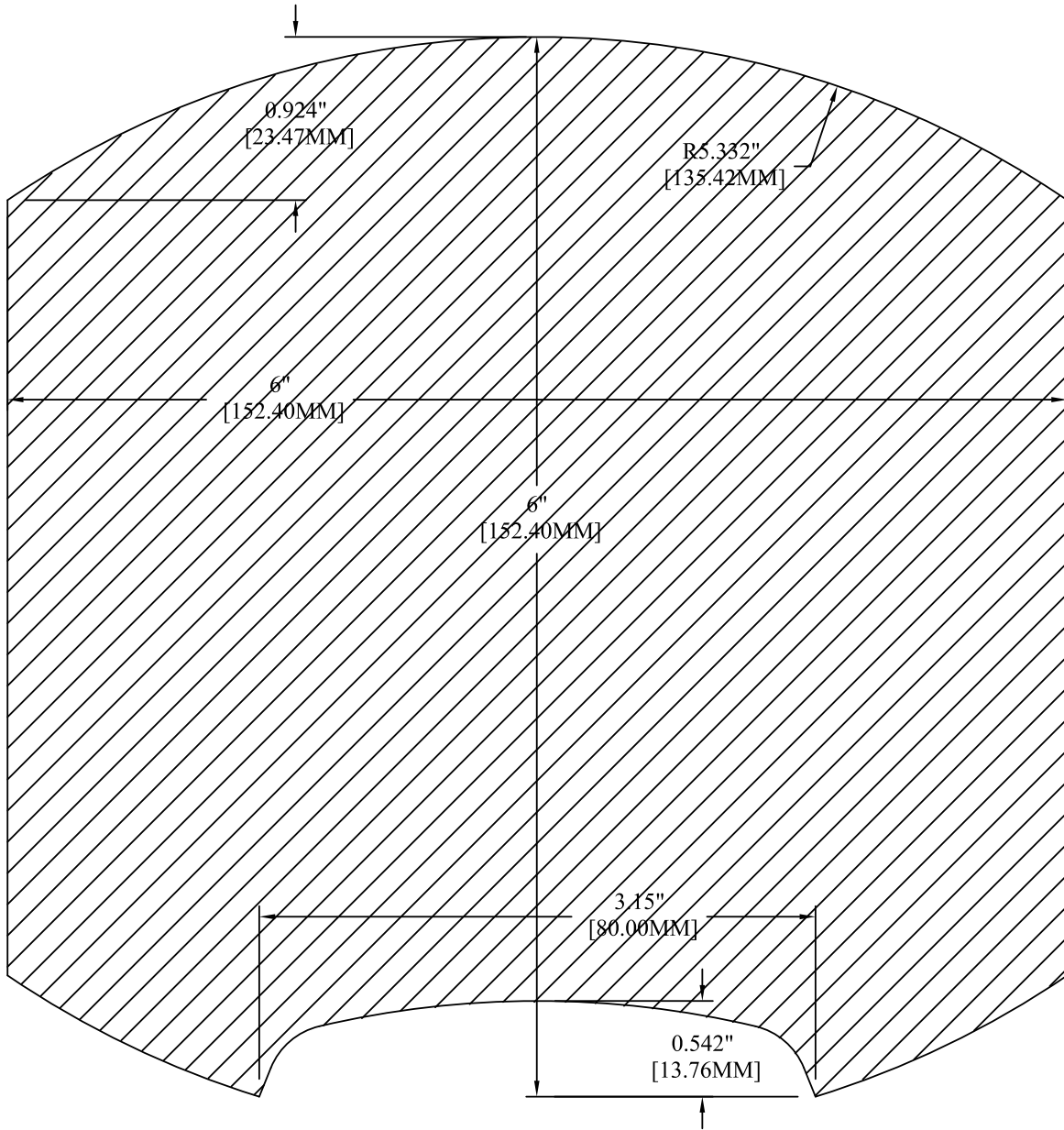

Log Moulder Profile #LM05

Drawings are NOT actual size.

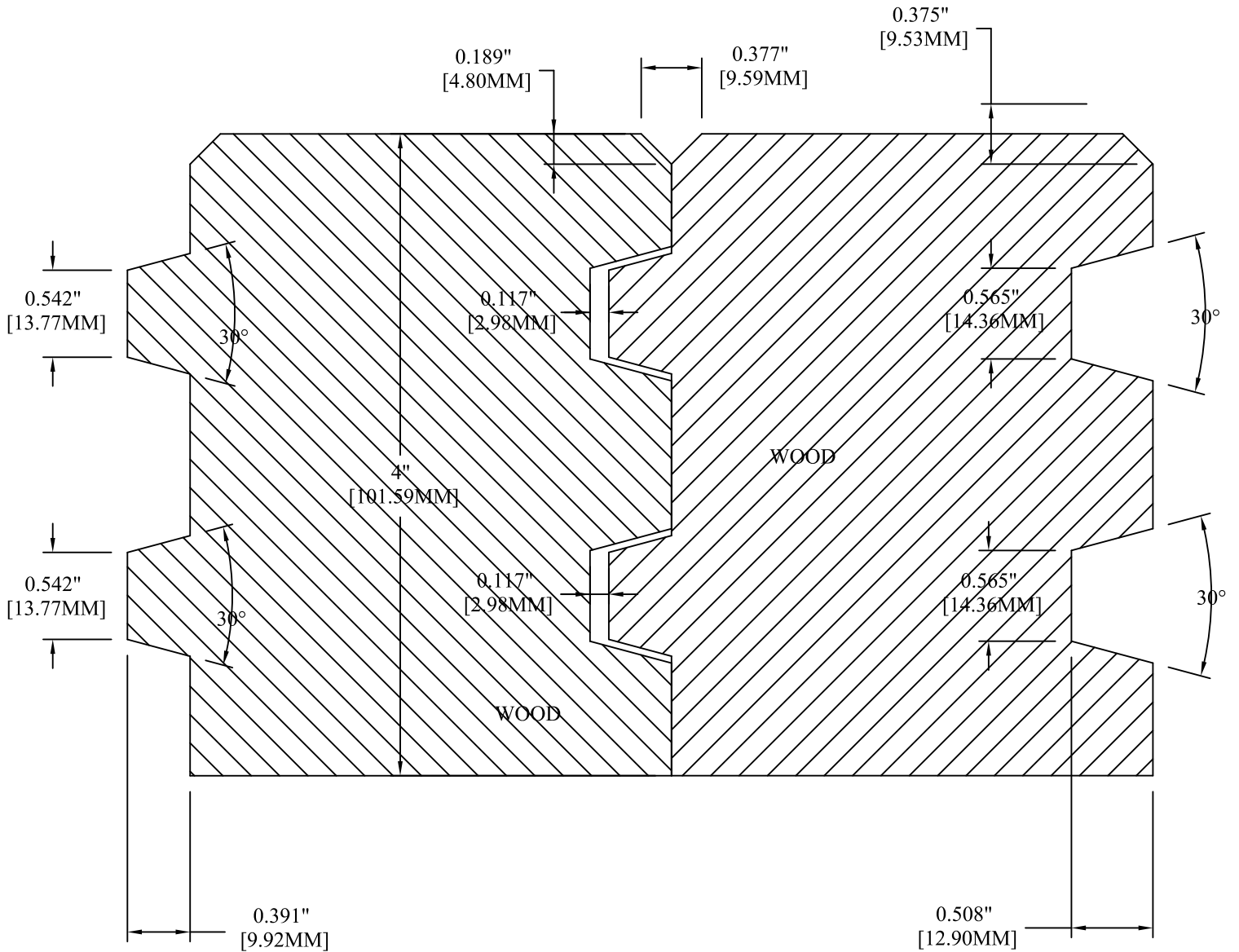

Log Moulder Profile #LM06

Drawings are NOT actual size.

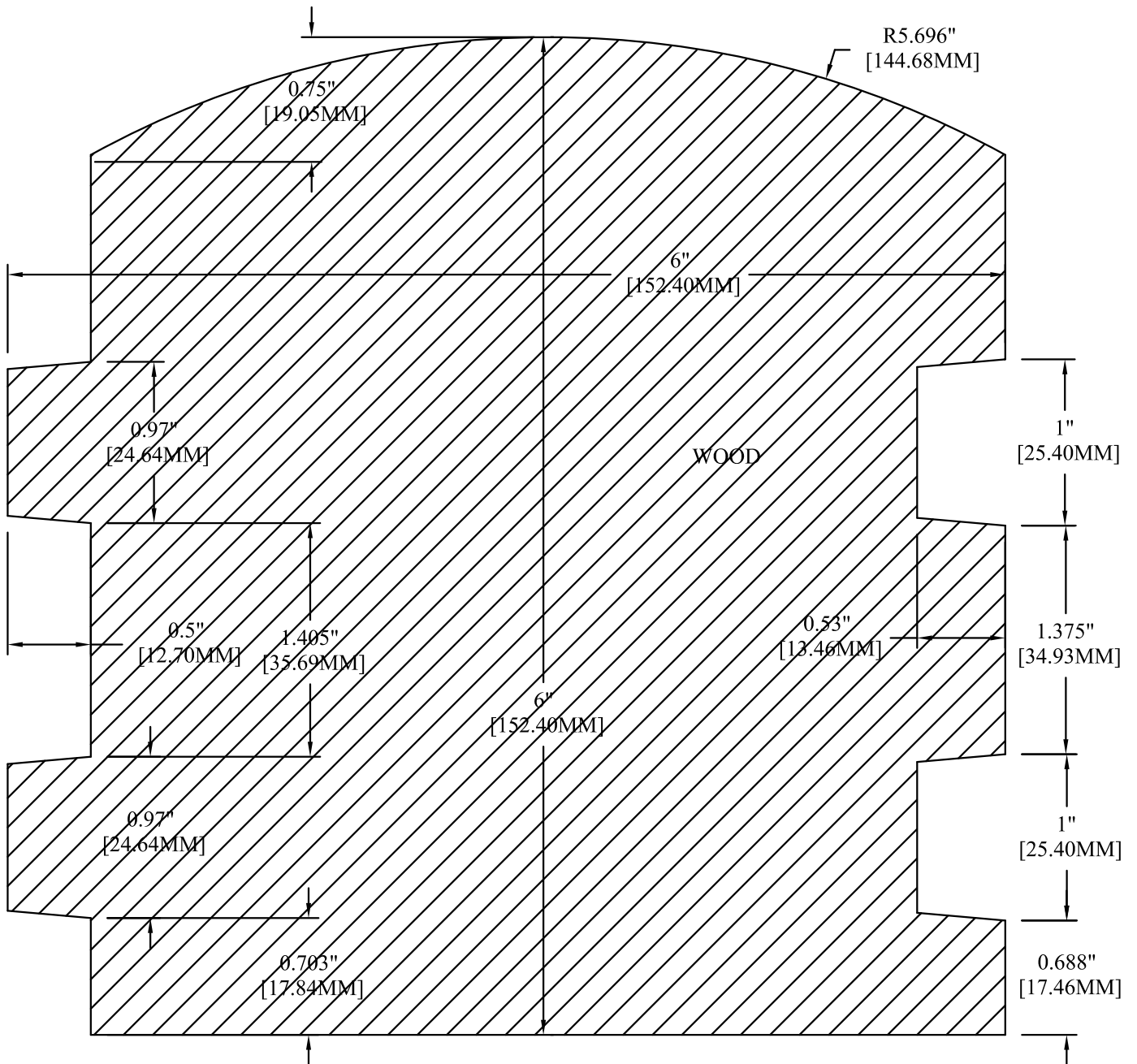

Log Moulder Profile #LM07

Drawings are NOT actual size.

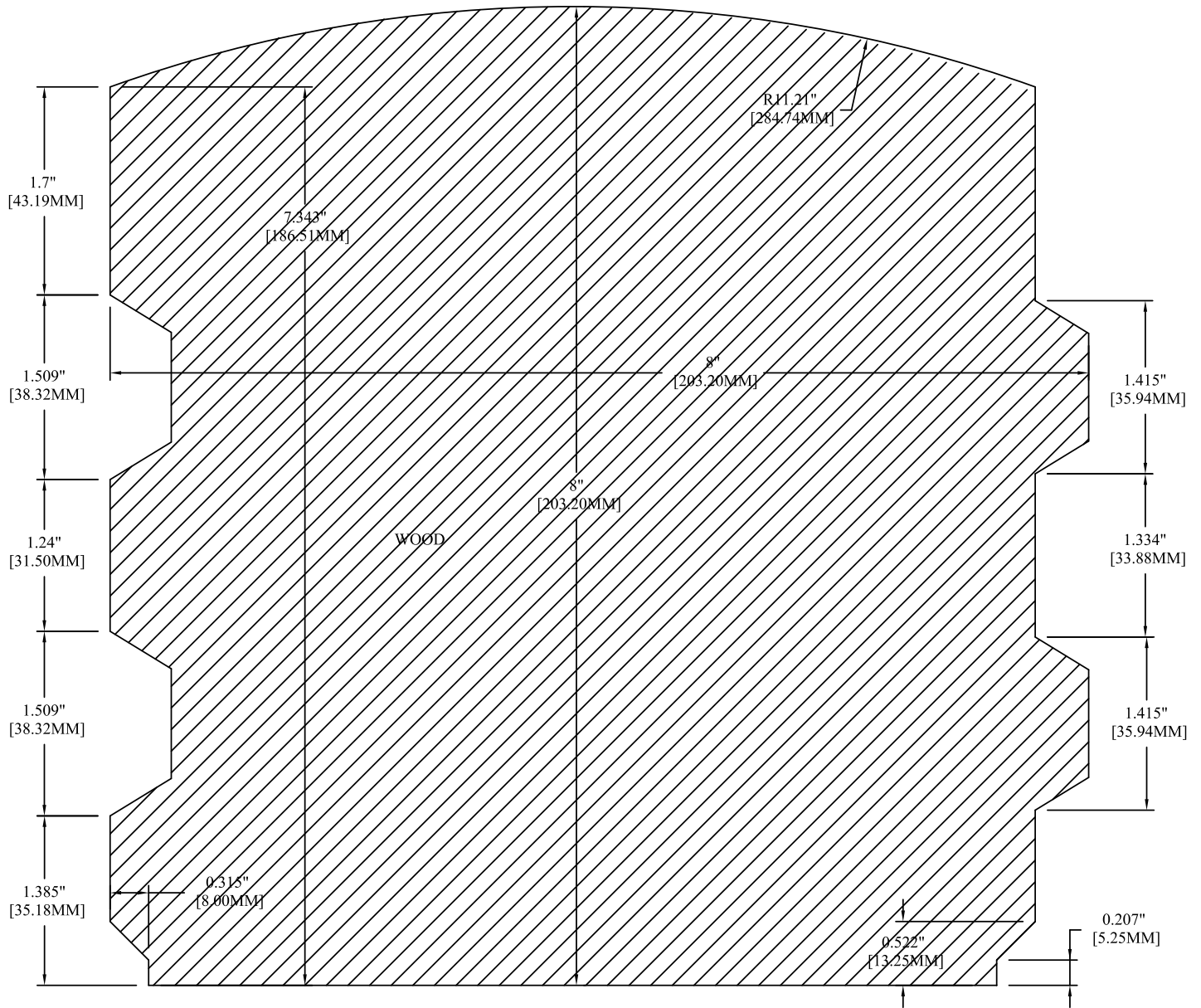

Log Moulder Profile #LM08

Drawings are NOT actual size.

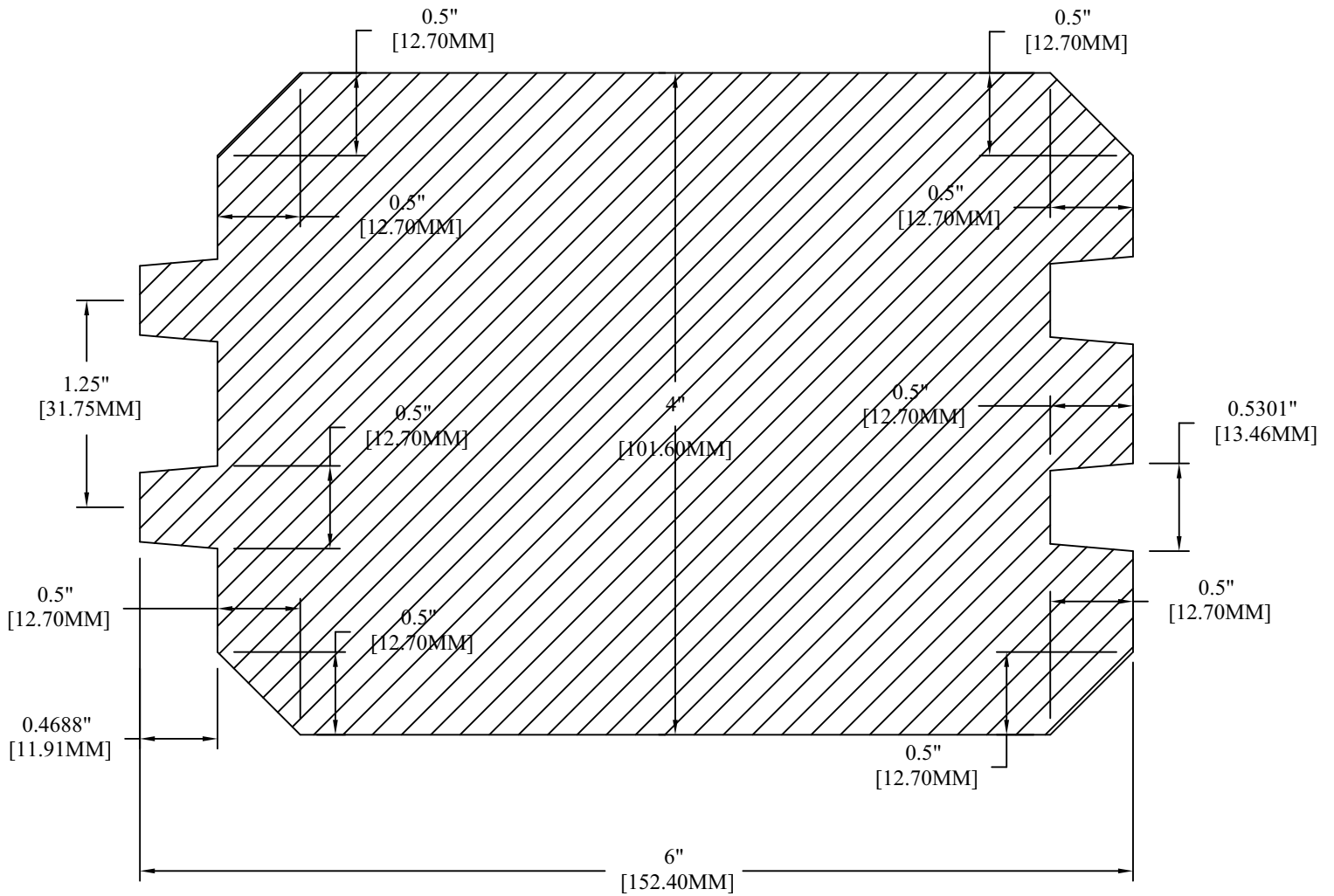

Log Moulder Profile #LM09

Drawings are NOT actual size.

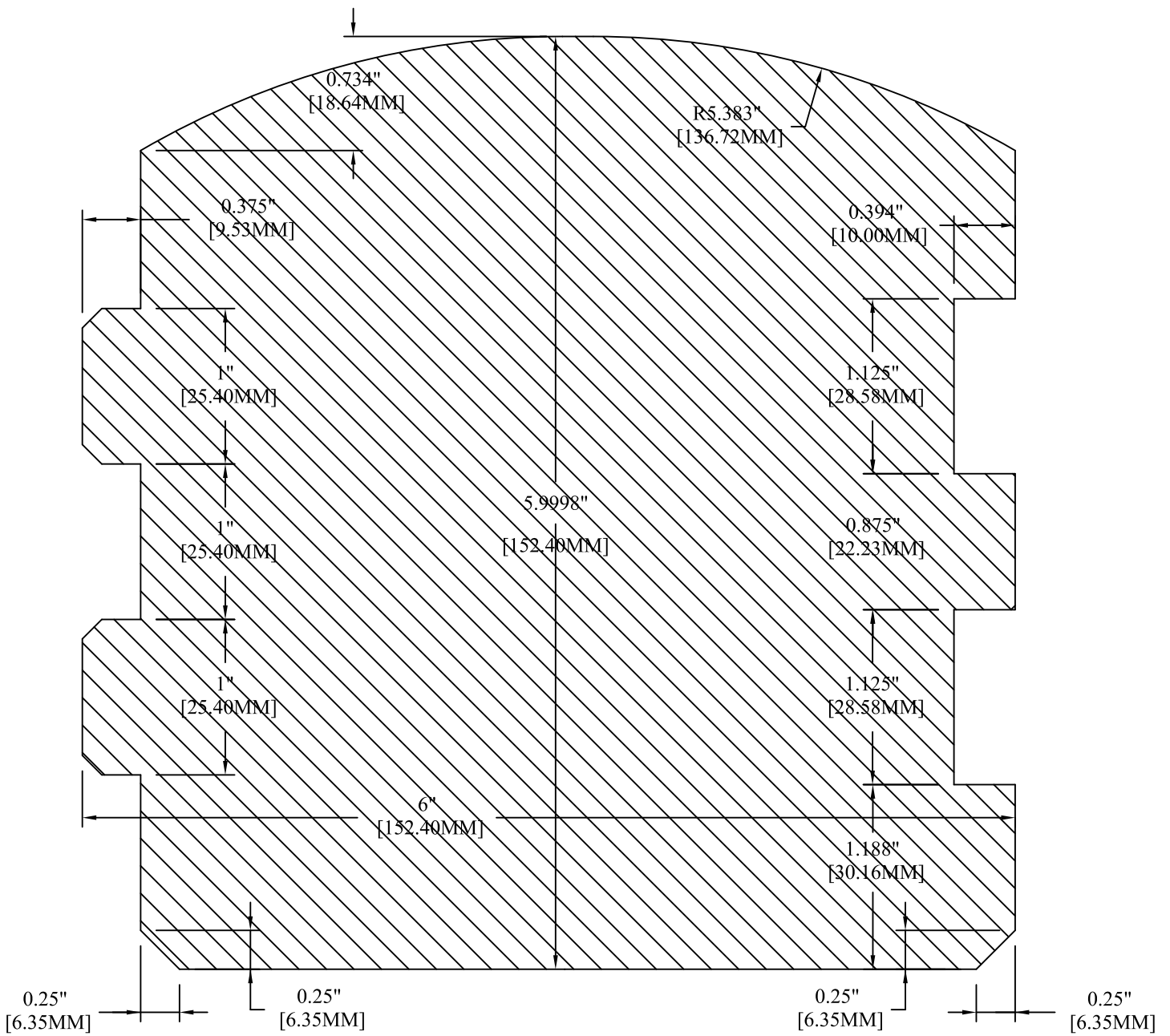

Log Moulder Profile #LM10



**We make knives
for most brands of
Molders and Log Molders
including:**

**Logosol, Baker, Jet, Woodmaster,
Norwood, W&H, Shop Fox,
Powermatic, Grizzly, General Int'l,
and more!**

***We also sell shaper knives,
planer blades, jointer blades,
and more!***

moldingknives.com

Tel: 1-866-499-8399

sales@moldingknives.com